

Schneider
Electric

TeSys LC1D..C 交流接触器
TeSys CAD..C 控制继电器

产品合格证
本产品经检验，符合标准

IEC60947/GB14048/GB21518，准予出厂



注意：电压危险！（WARNING: HAZARDOUS VOLTAGE）
操作之前请关闭电源，否则将导致伤亡。（Turn off all
power supplying this equipment before working on it.
Failure to follow this instruction will result in death or
serious injury.）

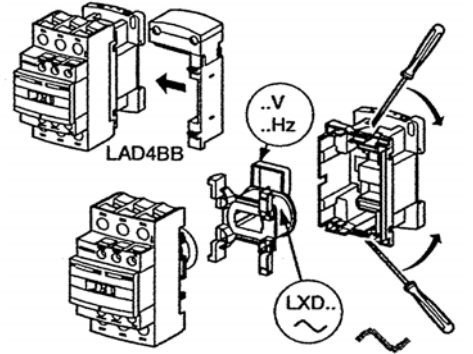

A

上海施耐德工业控制有限公司
SCHNEIDER SHANGHAI INDUSTRIAL CONTROL CO.,LTD.
中国上海普陀区绥德路629号 邮政编码:200331
629SUI DE ROAD, PUTUO, SHANGHAI 200331, CHINA

B

施耐德电气制造（武汉）有限公司
SCHNEIDER ELECTRIC MANUFACTURING (WUHAN) CO.,LTD.
中国武汉市东湖新技术开发区佛祖岭三路一号 邮政编码:430071
NO 1, 3RD ROAD OF FO ZU LING, DONGHU NEW&HIGH TECH DEV
ZONE WUHAN 430071, CHINA

当用于电动机启动时，请选用Schneider的LR系列热继电器。
(For Motor Starting Use Schneider Overload Relay Series LR)

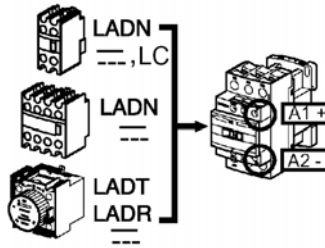
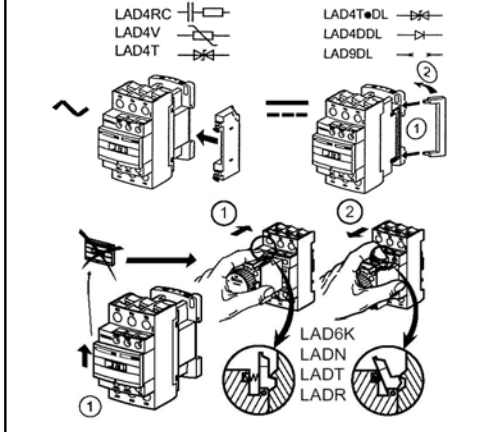

当有NTD熔断丝或额定运行短路分断能力不小于5000A的短路器保护下，可用于600V，预期短路电流为5000A的电路。（Suitable for
use on a circuit capable of delivering not more than 5000 rms sym.
amps. 600V max. when protected by NTD class fuses, or when
protected by a circuit breaker having a interrupting rating not less
than 5000rms. amps. 600v max.）

以下型号产品属于符合能效要求，产品的额定功率和能效等级如下：
The following products meet the Energy Efficiency requirements. The power consumption and Energy Efficiency grades are:

产品型号 (Product Type)	LC1D09..C	LC1D12..C	LC1D18..C	LC1D25..C	LC1D32..C	LC1D38..C
最大额定功率 (VA)	9.5	9.5	9.5	9.5	9.5	9.5
(Maximum power consumption lower than)						
能效等级 (Energy efficiency grade)	3	3	3	2	2	2

Schneider Electric Industries SAS
35, rue Joseph Monier
CS 30323
F - 92506 Rueil Malmaison Cedex

www.schneider-electric.com

CH01008 A13

© 2018 Schneider Electric - All rights reserved.

Schneider
Electric

1/1